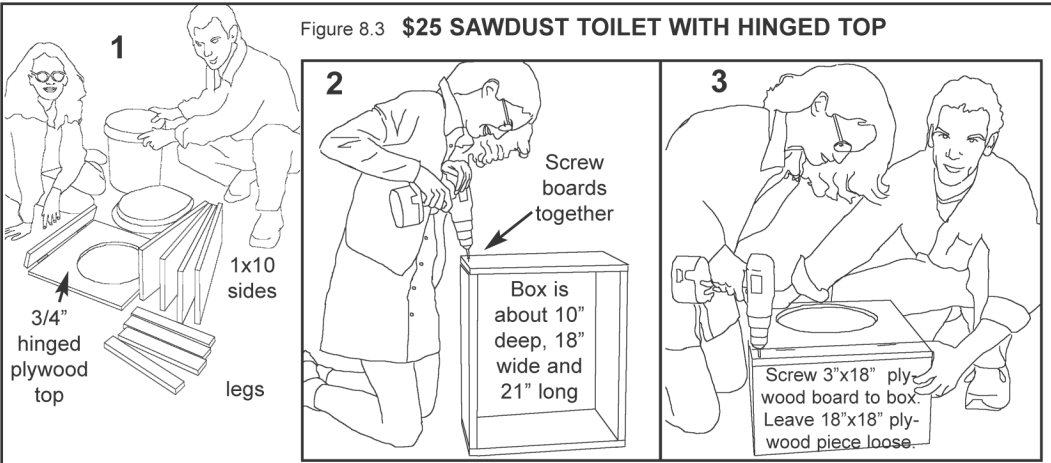
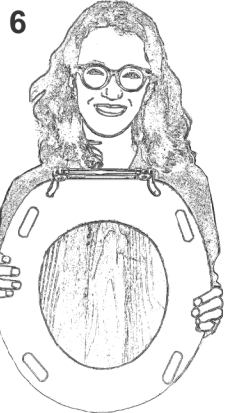
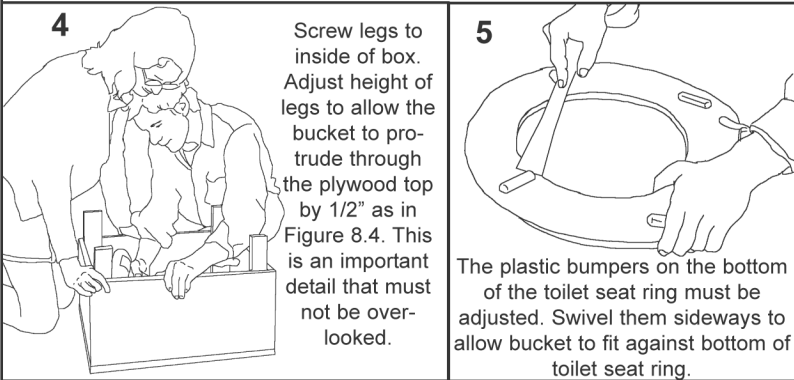

Figure 8.3 **\$25 SAWDUST TOILET WITH HINGED TOP**



A hinged sawdust toilet box will be 18" wide by 21" long. Get (2) boards 3/4"x10"x18", (2) 3/4"x10"x19.5", (2) hinges, (1) piece of 3/4" plywood 18"x18" and another 18"x3" and hinge them together. Cut a hole in the larger plywood to fit the top of a five-gallon bucket, set back one and one half inches from the front (as in Figure 8.4). Get four five-gallon buckets that are identical. Get (4) 3/4"x3"x12" legs. Get one standard toilet seat.



Adjusted toilet seat ring will look like this when finished.

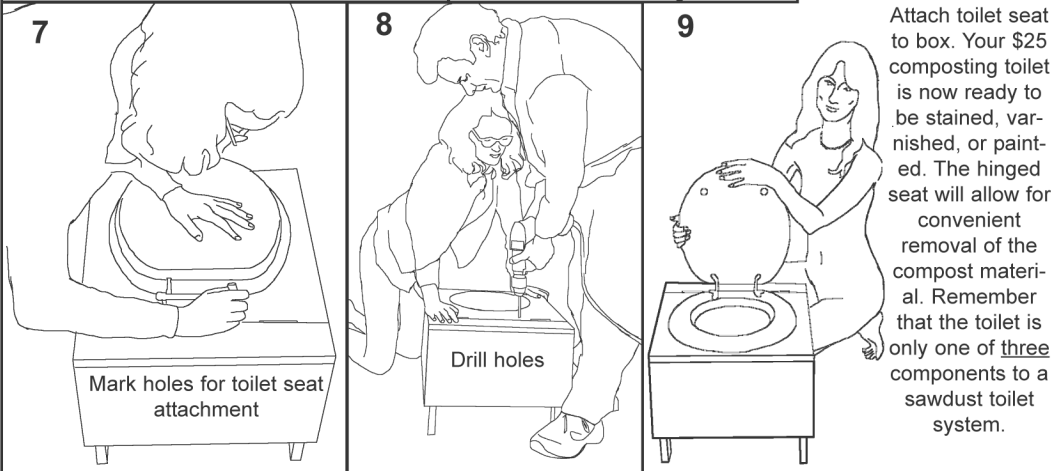

Attach toilet seat to box. Your \$25 composting toilet is now ready to be stained, varnished, or painted. The hinged seat will allow for convenient removal of the compost material. Remember that the toilet is only one of three components to a sawdust toilet system.